

Property Exhibit

of

Lot 1 of Certified Survey Map No. 1635,
recorded in Vol. 7 of Certified Survey Maps of Walworth County on Page
325 and located in the Southeast 1/4 of Section 18 and the Northeast 1/4 of
Section 19, Town 3 North, Range 15 East, Town of Richmond, Walworth
County, Wisconsin.

Prepared for:
Sugar Creek Dairy, LLC
N5633 County Road O
Elkhorn, Wisconsin. 53121

Tax Parcel
CR 1800002

Tax Parcel
CR 1800002D

(N78°47'30"E 689.60')
N78°49'17"E 689.35'

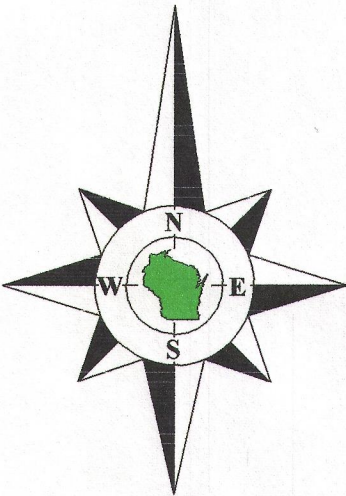

Bearings reference to Certified
Survey Map No. 1635.

Tax Parcel
CR 1800009

(403.78')
S0°59'23"E 438.04'
(S1°00'E 438.02')

Lot 1
Tax Parcel
CA163500001

7.340 Acres
319,722 Sq.Ft.
6.806 Acres
296,484 Sq.Ft.
Exclusive of R.O.W.

(N1°00'W 504.02')
N0°59'04"W 504.40'
470.15'
(469.78')

South 1/4 Corner
Section 18-3-15
N. 261.603.43
E. 2,330.956.07

(N88°47'40"E 2640.44') State Plane
N89°44'02"E 2640.41'

South line of the Southeast 1/4 Section 18-3-15.
North line of the Northeast 1/4 Section 19-3-15.

Southeast Corner
Section 18-3-15
N. 261.658.98
E. 2,333.595.82

Tax Parcel
CR 1900001A

(S73°30'00"W 704.29')
S73°30'00"W 704.17'

(S73°30'00"W 704.29')
S73°30'00"W 704.17'
(S73°30'00"W 704.29')

County Trunk Highway A (66' Wide)

Notes:

- 1) This Property Exhibit is not an original unless signed and sealed in red ink.
- 2) This exhibit is subject to Wisconsin lien laws. This Property Exhibit is the notice of intent to file lien. Lien waiver required.

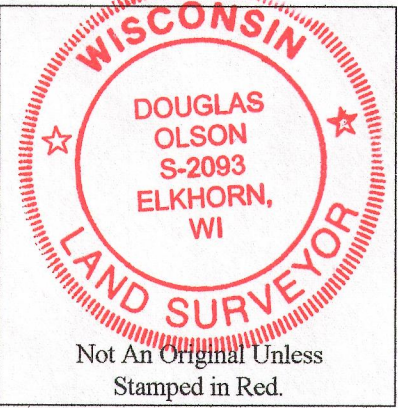

Copyright 2013 by Jensen & Olson Land Surveying, LLC.

All rights reserved. No part of this survey plat may be reproduced or transmitted in any form by any means - graphic, electronic, or mechanical, including photocopying, tracing, or information storage and retrieval systems - without permission in writing from Douglas G. Olson, Jensen & Olson Land Surveying, LLC.

I, Douglas G. Olson, Wisconsin Registered Land Surveyor, do hereby certify that this survey was performed by me, or under my direction in full compliance with the owner's/agent's instructions and Chapter A-E 7 of the Wisconsin Administrative Code "Minimum Standards for Property Surveys"; and that this map is an accurate representation thereof to the best of my knowledge and belief.

Douglas G. Olson
Wisconsin Registered Land Surveyor - 2093

Survey Date: March 22, 2013.
Revisions:

Scale in Feet
1" = 50'
0' 25' 50' 100'

Jensen & Olson Land Surveying, LLC
45 South Wisconsin Street * P.O. Box 322 * Elkhorn, Wisconsin. 53121
Telephone: (262) 723-3434 * Facsimile: (262) 723-8044
Email: jensen.olson@elknet.net

Legend

- Found County Section Corner
- Found Iron Pipe
- Found Iron Rod with Cap
- Set 60d Spike
- Recorded Information

Sheet 1 of 1 Sheets
Drawing Name: Garl Sec-201-20130101Exhibits

Job Reference Number
2013.021

2013.021

315-1201